

PASSED

IN THE BOARD OF COUNTY COMMISSIONERS OF LANE COUNTY
STATE OF OREGON

ORDER NO.

05-2-2-4

) IN THE MATTER OF AMENDING THE 2005-
) 2009 CAPITAL IMPROVEMENT PROGRAM
) (CIP) IN FY 04-05 BY: 1. MOVING FUNDS FOR
) MILL ROAD AT HWY 58 FROM FY 06-07 TO
) FY 04-05; 2. ADDING \$40,000 IN ADDITIONAL
) FUNDS FOR LANE TRANSIT DISTRICT (LTD)
) IMPROVEMENTS ASSOCIATED WITH THE
) MARTIN LUTHER KING, JR BOULEVARD
) PROJECT; AND AUTHORIZING THE COUNTY
) ADMINISTRATOR TO EXECUTE
) INTERGOVERNMENTAL AGREEMENTS
) NECESSARY TO IMPLEMENT THESE
) ACTIONS.

WHEREAS, the Oregon Department of Transportation (ODOT) has requested County financial participation in the replacement of a bridge on Highway 58 at MP 8.08 and associated turn lane improvements at Mill Road near the bridge; and

WHEREAS, the Lane Transit District (LTD) has made a request for funds for BRT related improvements associated with the construction of Martin Luther King Jr Boulevard in Springfield; and

WHEREAS, the Lane County Board of Commissioners discussed these requests on February 2, 2005 at their regular meeting; and

WHEREAS, the Board wishes to approve these requests, **NOW, THEREFORE IT IS HEREBY**

ORDERED that the FY 2005-2009 CIP be amended as follows:

- 1. Mill Road at Highway 58, Move \$385,000 from FY 06-07 to FY 04-05
- 2. LTD Improvements on Martin Luther King Jr Boulevard, Add \$40,000 in FY 04-05. and

IT IS FURTHER ORDERED that the County Administrator execute intergovernmental agreements, as necessary to implement these actions, as follows:

1. The agreement for Mill Road at Highway 58 shall indicate that the \$385,000 in County funds is a not-to-exceed amount. Further, the purpose of these funds is to facilitate the construction of a left turn lane eastbound and a right turn lane westbound at the Mill Road intersection with Highway 58.

2. The agreement for the improvements requested by LTD for Martin Luther King Jr Boulevard shall indicate that the \$40,000 in County funds is a not-to-exceed amount.

Dated this 2nd day of February, 2005.

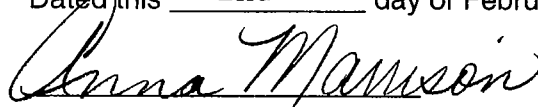

Anna Morrison, Chair

Lane County Board of Commissioners

APPROVED AS TO FORM

Date: 1-23-05 Lane County

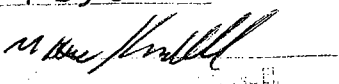

CLERK

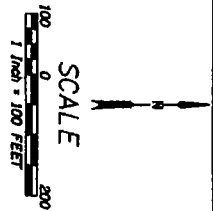
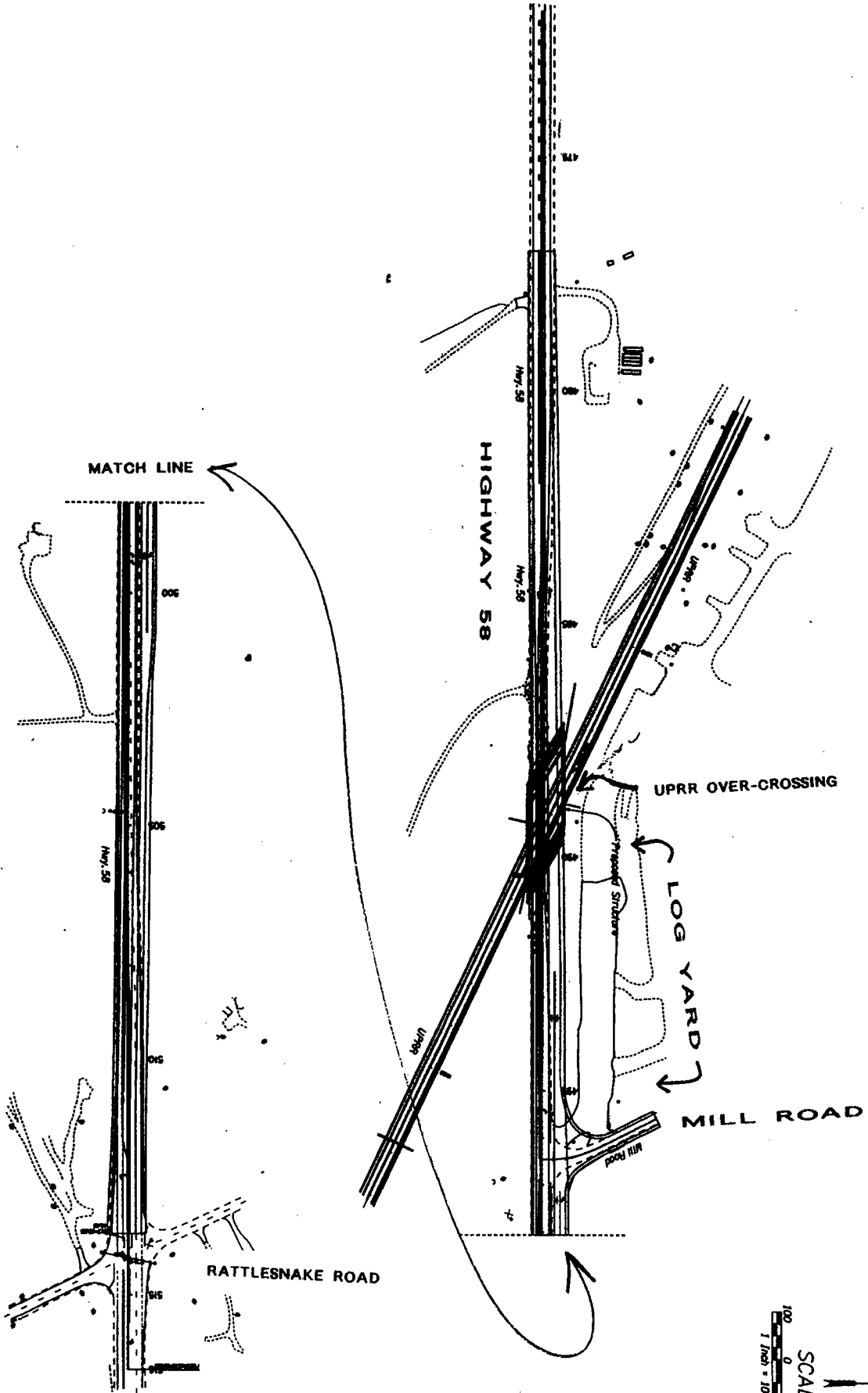



Lane Transit District

P.O. Box 7070

Eugene, OR 97401-0470

(541) 682-6100 (voice)

(541) 682-6111 (fax)

(800) 735-2900 (TTY)

ltd@ltd.org (e-mail)

www.ltd.org (Internet)

October 21, 2004

Lane County Board of Commissioners
 Lane County Courthouse
 125 East Eighth Avenue
 Eugene, Oregon 97401

RE: Request for Road Funds

Dear Commissioners:

We thank you for your far-sighted decision to add additional right-of-way in the southern segment of the Martin Luther King Jr. Parkway in order to accommodate transit priority lanes for the EmX system. At this time, we are coming to you seeking \$40,000 in Lane County Road Funds for the construction of a combination right turn/transit lane on the northbound approach of the MLK Jr. Parkway at RiverBend Drive. As explained below, this element of the project is eligible for Road Funds but is not eligible for funding through the Federal Transit Administration.

Staff from the County, the City of Springfield, and LTD have been fine-tuning the design of the MLK Jr. Parkway. For transit priority, the southbound approach (toward the roundabout at Hayden Bridge Road) will be a median transit-only lane. For the northbound direction, approaching RiverBend Drive, it has been decided that a combination transit and right turn lane on the curbside would be the safest and most effective design. With the narrower right-of-way, the right turn lane had to be shortened to the point that it would not accommodate the design-year traffic volumes. With the wider right-of-way, the right turn lane has been extended to function better for all right-turning vehicles including transit. Since there is little interference with the right turn movement, this lane should flow well and result in minimal delay for LTD. Attached is a drawing that shows the lane configurations.

The timing of the MLK Jr. Parkway construction and the EmX corridor construction would not be concurrent if LTD waits for federal funding. It clearly is clearly most efficient and least disruptive to the community to build the transit priority lanes on MLK Jr. Parkway at the same time that the rest of the street is constructed. Consequently, the LTD Board has decided that the transit lanes should be constructed at the same time that the rest of the road is constructed, even if that means that federal funds cannot be used on that portion of the work. It is estimated that construction of the transit lanes when the road is under construction would be 30 to 40 percent less expensive than to add the transit lanes after the road has been completed.

RECEIVED
 OCT 21 2004

Lane County Board of Commissioners
October 21, 2004
Page 2

LTD is investigating funding opportunities for the transit priority lanes. Since the northbound extension of the right turn lane is for mixed traffic, it is eligible for County Road Funds. The cost for the northbound right turn lane extension and associated impacts to utilities has been estimated to be approximately \$40,000 (\$22,000 for the lane extension, \$12,000 to relocate a power pole, and \$6,000 for design and contingency). LTD requests an increase in the allocation of Road Fund dollars to the MLK Jr. Parkway to cover this portion of the work.

Thank you very much for your consideration of this request. Please do not hesitate to contact me or LTD Director of Development Services Stefano Viggiano with any questions about this request.

Sincerely,

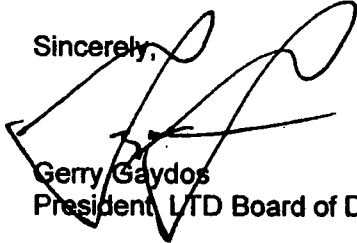

Gerry Gaydos
President LTD Board of Directors

Cc: Bill Van Vactor
Ollie Snowden
Tom Stinchfield
Sonny Chickering
Mike Pattle

Attachments

MLK Jr Parkway - Right-turn lane

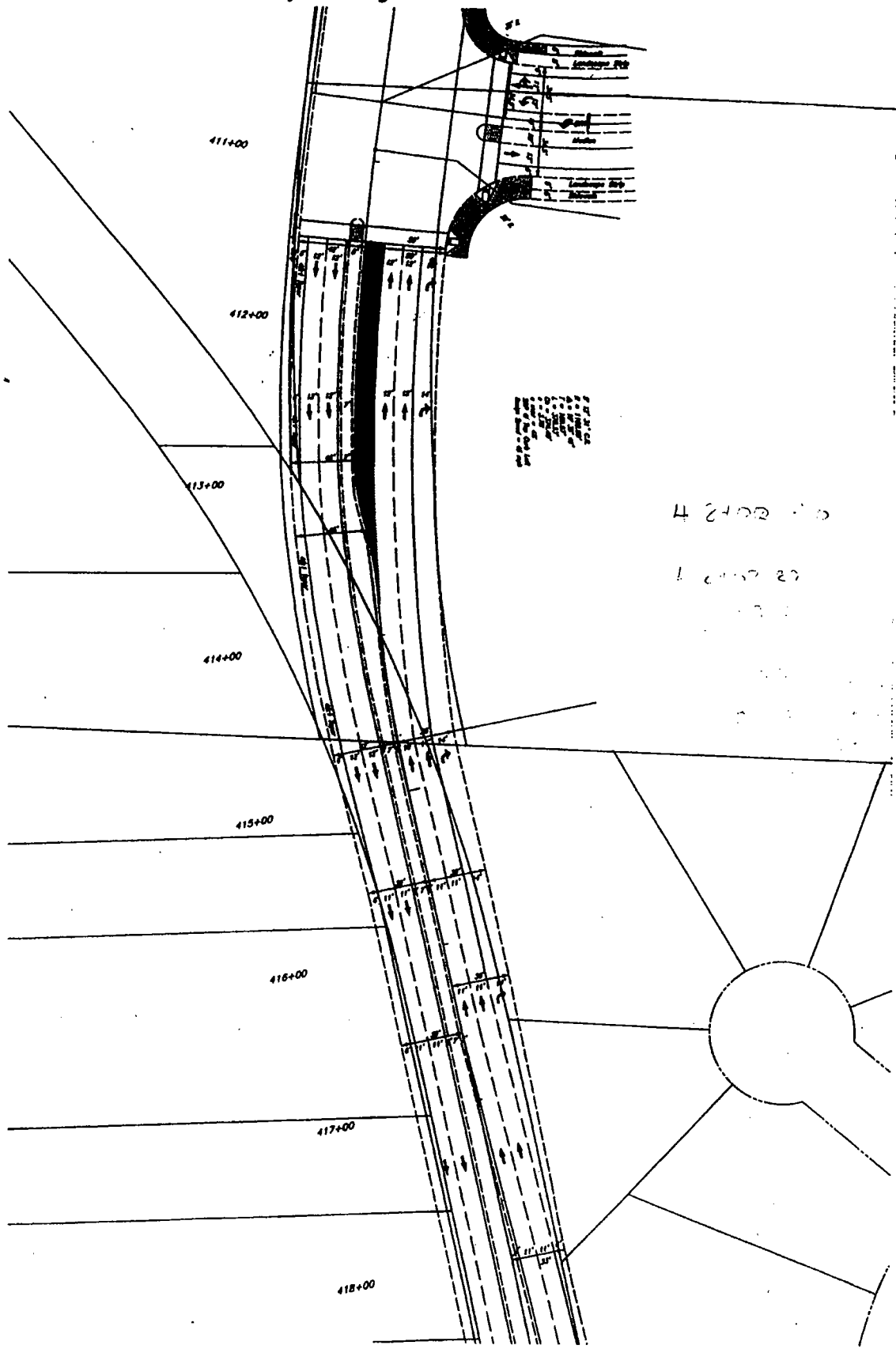

4 2100 7 0
1 2100 20