

IN THE BOARD OF COUNTY COMMISSIONERS OF LANE COUNTY
STATE OF OREGON

PASSED

FILE NO. 4111

IN THE MATTER OF SETTING A PUBLIC HEARING) RESOLUTION,
ON THE PROPOSED SURRENDER OF PORTIONS) NOTICE OF HEARING
OF SOUTH GARDEN WAY (COUNTY ROADS NUMBER) AND ORDER NO.
307, 388, 531 AND 1304), TO THE CITY OF EUGENE)
04-1-20-2

WHEREAS, the City of Eugene, by its Ordinance No. 20304, requested that jurisdiction over portions of South Garden Way, County Roads Number 307, 388, 531 and 1304 that lie within the city limits, be transferred to the City of Eugene within 150 days of said Ordinance; and

WHEREAS, the amended County/City Roads Partnership Program Agreement of July 1, 2003 between Lane County and the City of Eugene called for the surrender of County Roads which have been annexed into the city and the public's interest was determined to be benefited when this agreement was reached; and

WHEREAS, ORS 373.270 provides for the surrender and transfer of jurisdiction over County Roads within a City. The County may transfer jurisdiction over County Roads or parts thereof within a city when it is considered to be necessary, expedient, or in the best interest of the County to do so; and the governing body of the City deems it necessary or expedient and in the best interest of the City to acquire jurisdiction over the County Roads or portions thereof and to the same extent as it has over public streets and alleys of the City; and

WHEREAS, Lane County and the City of Eugene deem it necessary and expedient and in the best interest of each governing body to proceed with the surrender and transfer of jurisdiction over the above described County Roads, now therefore, it is hereby

ORDERED, that a public hearing be set for February 25, 2004 at 1:30 p.m., at the Lane County Courthouse, 125 East 8th Avenue, Eugene, Oregon, to formally consider the surrender of the portions of South Garden Way, County Roads Number 307, 388, 531 and 1304, as described in Exhibit "A" attached hereto and made a part hereof by this Order, to the City of Eugene; and further, it is hereby

ORDERED, that legal notice of hearing be posted or published, in accordance with ORS 373.270; and further; it is hereby

ORDERED, that the Director of the Lane County Department of Public Works prepare and provide a final report on the proposed surrender.

Inquiries regarding these surrender proceedings may be directed to Bill Robinson, Lane County Surveyor, Public Service Building, 125 E. 8th Avenue; Eugene, OR 97401, telephone (541) 682-4195.

DATED this 20th day of January, 2004

Chair
LANE COUNTY BOARD OF COMMISSIONERS

APPROVED AS TO FORM
Date 1-8-04 lane county

OFFICE OF LEGAL COUNSEL

EXHIBIT "A"

LEGAL DESCRIPTIONS	MILEAGE

SOUTH GARDEN WAY (COUNTY ROAD NUMBER 307 AND 388) from the former Eugene city limits near the southwesterly right of way line of Interstate 105/ Interstate 5, Southerly, 1525 feet, more or less, to the present city limits, all in Section 28, Township 17 South, Range 3 West of the Willamette Meridian.	00.29
--	-------

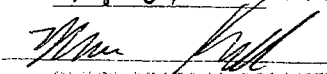
SOUTH GARDEN WAY (COUNTY ROAD NUMBER 531) from the west end of County Road No. 531, as established with Centennial Boulevard in 1966, being the easterly boundary of the previous city limits and the east line of Parcel 1 of Land Partition Plat No. 94-P0521, Lane County, Oregon Plat Records, Easterly 100 feet, more or less, to the present Eugene city limits, all in Section 28, Township 17 South, Range 3 West of the Willamette Meridian.	00.02
--	-------

SOUTH GARDEN WAY (COUNTY ROAD NUMBER 1304), originally established as a connector to Centennial Boulevard, from the north line of said Centennial Boulevard (now Martin Luther King Jr. Boulevard), Northerly, 145 feet, more or less, to the south line of County Road No. 531, all in Section 28, Township 17 South, Range 3 West of the Willamette Meridian.	00.03
---	-------

EXHIBIT "B"

IN THE BOARD OF COUNTY COMMISSIONERS OF LANE COUNTY
STATE OF OREGON

FILE NO. 4111

IN THE MATTER OF SETTING A PUBLIC HEARING)
ON THE PROPOSED SURRENDER OF PORTIONS) PRELIMINARY
OF SOUTH GARDEN WAY (COUNTY ROADS NUMBER) DIRECTOR'S
307, 388, 531 AND 1304), TO THE CITY OF EUGENE) REPORT

The City of Eugene is requesting the surrender of portions of County Roads Number 307, 388, 531 and 1304 (South Garden Way) located within the city limits.

South Garden Way consists of portions of County Roads Number 307 and 388 (Campbell Road, established in 1874 and 1884, respectively), County Road No. 531 (W.T. Pattison Road established in 1903) and County Road No. 1304 (Centennial Boulevard established in 1960).

The City of Eugene has enacted Ordinance No. 20304 formally requesting that the jurisdiction over the above said portions of County Road, all within the city limits and described in the attached Resolution and Order, be transferred from Lane County to the City of Eugene. This action by the City is in accordance with the amended County/City Roads Partnership Program Agreement of July 1, 2003 and necessary to facilitate the City's planned reconstruction and improvement of the road.

ORS 373.270 provides for the transfer of jurisdiction over County Roads within a city. The county may transfer jurisdiction over county roads or portions thereof within a city when it is considered to be necessary, expedient or for the best interest of the county to do so; and the governing body of the city deems it necessary or expedient and for the best interest of the city to acquire jurisdiction over the portion of county road to the same extent as it has over public streets and alleys of the city.

The proposed surrender would enable the city to maintain, develop, improve, and use the road for the surrounding area to its own specifications, standards, and timetables.

It is recommended that a public hearing date be established on the proposed surrender of jurisdiction of portions of South Garden Way, County Roads Number 307, 388, 531 and 1304, as described in the Resolution and Order.

DATED this 6th day of January, 2004

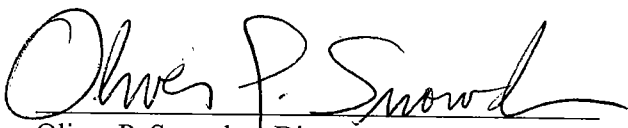

Oliver P. Snowden, Director
Department of Public Works

SECTION 28, T 17 S, R 3 W, W. M.
LANE COUNTY.

No Scale

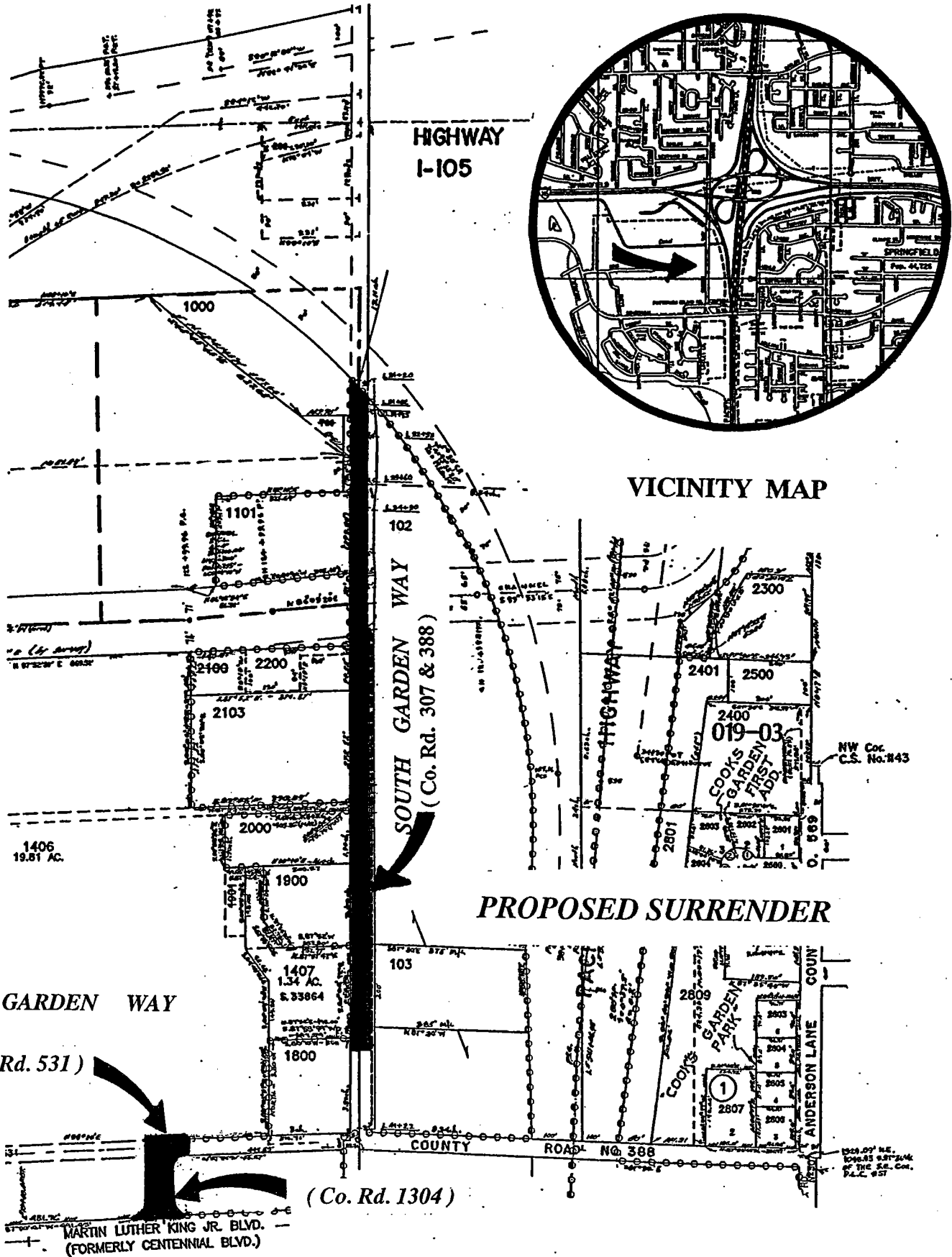

VICINITY MAP

PROPOSED SURRENDER

SOUTH GARDEN WAY

(Co. Rd. 531)

(Co. Rd. 1304)

MARTIN LUTHER KING JR. BLVD.
(FORMERLY CENTENNIAL BLVD.)

NW Cor.
C.S. No. 843

1000.00' NE.
1000.00' SE.
1000.00' SW.
1000.00' NW.
OF THE S.E. COR.
P.L.C. 95'