

BEFORE THE BOARD OF COMMISSIONERS OF LANE COUNTY, OREGON

ORDER NO: 17-09-26-03

IN THE MATTER OF AUTHORIZING THE  
SALE OF COUNTY OWNED REAL  
PROPERTY FOR \$1,300 TO CYNTHIA A.  
BEAL, FORMER OWNER OF RECORD,  
MAP NO. 16-06-18-00-00405

**WHEREAS** this matter now coming before the Lane County Board of Commissioners and the Board deeming it in the best interest of Lane County to sell the following real property which was acquired through tax foreclosure, to wit:

See attached Exhibit "A".

**WHEREAS**, Cynthia A. Beal is the former owner of record; and

**WHEREAS**, Ms. Beal met the requirements of Lane Manual 21.425(4) during the foreclosure and redemption period and has provided documentation of such.

**NOW, THEREFORE**, the Board of County Commissioners of Lane County **ORDERS** as follows:

1. Pursuant to ORS 275.180 and Lane Manual 21.425(4) the above described real property be sold to Cynthia A. Beal for \$1,300.
2. The Board Chair is authorized to execute the Quitclaim Deed.
3. The proceeds be disbursed through the Foreclosure Program.

**ADOPTED** this 26th day of Sept., 2017



Pat Farr, Chair, Lane County Board of Commissioners

APPROVED AS TO FORM

Date 9/26/17

LANE COUNTY OFFICE OF LEGAL COUNSEL

**EXHIBIT "A"**

**Legal Description  
16-06-18-00-00405**

A portion of the Northeast one-quarter, Section 18, Township 16 South, Range 6 West of the Willamette Meridian, Lane County, Oregon, described as follows:

Beginning at the intersections of the West margin of State Highway No. 36 and the North line of Section 18, which point is South 89° 30' West 305.72 feet from the Northeast corner of Section 18; thence South 89° 30' West 1350 feet along the North line of Section 18, to the most Northerly, Northeast corner of a tract sold to Bohemia Inc., an Oregon corporation by Instrument recorded on June 28, 1978, Reel 921, as Reception No. 78-44589, Official Records of Lane County; thence South 2° 26' East, 300 feet; parallel to the East line of Section 18; thence North 89° 30' East 1350 feet more or less, parallel to the North line of Section 18, to the West margin of the Siuslaw Highway (Hwy. 36); thence Northwesterly along the West line of Highway 36 to the Point of Beginning.

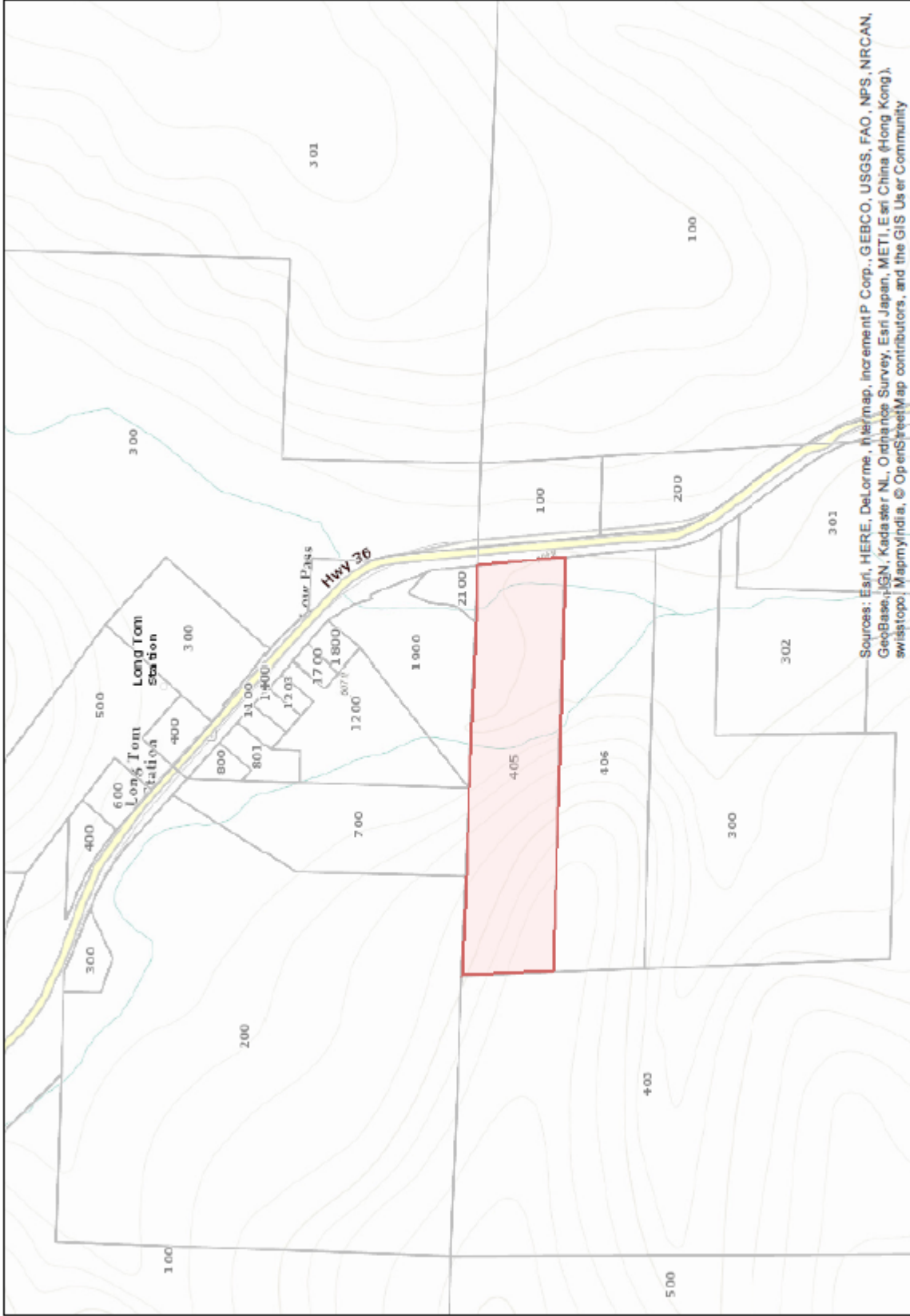

Sources: Esri, HERE, DeLorme, Intermap, increment P Corp., GEBCO, USGS, FAO, NPS, NRCAN, GeoBase, IGN, Kadaster NL, Ordnance Survey, Esri Japan, METI, Esri China (Hong Kong), Swisstopo, MapmyIndia, © OpenStreetMap contributors, and the GIS User Community

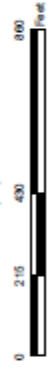

The information on this map was collected from aerial photography of the area. Lane County Geographical Information Systems, Corvallis, Oregon, is the source of this map. It is provided "as is". Lane County cannot accept any responsibility for errors, omissions or partial accuracy in the digital data or the resulting information. The user assumes all responsibility for the accuracy of the information. Lane County Geographical Information Systems, Corvallis, Oregon, is not responsible for any errors or omissions, inaccuracies, or any other consequences that may result from the use of this information.

### CPITS Web Map



Lane County, Oregon